



Vertically Integrated, Made in the USA

THE SPECIALTY MFG. CO.

5858 Centerville Road • St. Paul, MN 55127-6804

Tel: (651) 653-0599 • Fax: (651) 653-0989

www.specialtymfg.com • e-mail: info@specialtymfg.com

810 SERIES CHECK VALVE

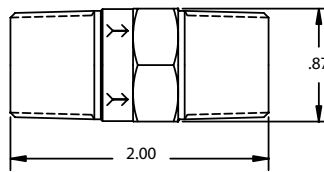
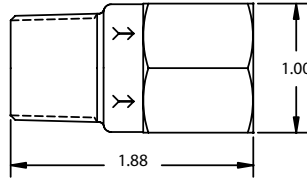

Design Considerations

The 810 Series Piston Check Valve incorporates a piston with an embedded o-ring that seals on the seat. Pressure in the flow direction moves the piston and seal off the seat and exposes the cross holes in the piston. The 810 Series Check Valve maximum operating pressure of 500 psi covers a wide range of air and fluid applications. The 810 Check is a compact design and has a positive seal at very low back pressure or slight vacuum.

- Maximum Operating Pressure — 500 psi
- Maximum Operating Temperature — 180°F
- Seat Area Open Diameter — .375

Options

Material Options	Brass Body and Piston Beryllium Copper Retainer
Seal Options	Buna-N, Ethylene Propylene, Fluoroelastomer (Viton®), Neoprene
Brass End Options	1/2 MNPT Inlet x 1/2 MNPT Outlet 1/2 MNPT Inlet x 1/2 FNPT Outlet 1/2 FNPT Inlet x 1/2 MNPT Outlet
Cracking Pressure	302 Stainless Spring - 1/3, 1/2 psi, 1 psi (Standard), 2, 5, 12 psi, No Spring
Plating Options	No Plating (Standard), Electroless Nickel

Example of How To Order

Body Material Brass	Inlet End 1/2 FNPT	Outlet End 1/2 MNPT	Seal Viton®	Spring 5 psi	Plating None
-------------------------------	------------------------------	-------------------------------	-----------------------	------------------------	------------------------

SMC Part Number: CHK BRS 810-8F8M-F,5#

The flow arrow on the body will point from Inlet to Outlet. SMC Part Numbers are a description of the valve as read left to right, Inlet to Outlet.

Example: CHK BRS 810-8F8M-F,5# = 1/2 FNPT Inlet x 1/2 MNPT Outlet

SMC will quote alternate materials or customize our standard products when quantities ensure competitive pricing.