



Vertically Integrated, Made in the USA

**THE SPECIALTY MFG. CO.**

5858 Centerville Road • St. Paul, MN 55127-6804  
 Tel: (651) 653-0599 • Fax: (651) 653-0989  
 www.specialtymfg.com • e-mail: info@specialtymfg.com

## 460 SERIES CHECK VALVE

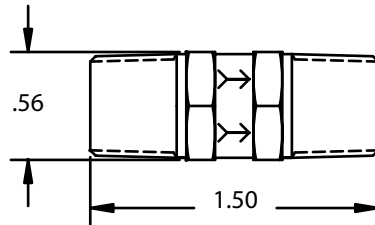
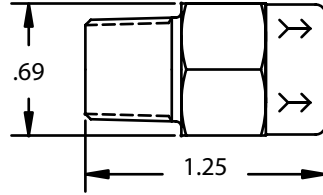

### Design Considerations

The 460 Series Ball Check Valve is designed for high pressure - light hydraulics, high pressure fluid or air. The 460 Check incorporates a stainless ball on a brass seat in the check valve body. The 460 Check will have a positive seal only at high back pressure. There is no elastomer in the check valve to create a positive seal and there may be some leakage past the seat in low back pressure applications.

- Maximum Operating Pressure — 2500 psi
- Maximum Operating Temperature — 180°F
- Seat Area Open Diameter — .187

### Options

<b>Material Options</b>	Brass Body and Stop, 440 Stainless Ball, 15-7 Retainer 316 Stainless Body and Stop, 440 Stainless Ball, 15-7 Stainless Retainer
<b>Brass Body Options</b>	1/4 MNPT Inlet x 1/4 FNPT Outlet 1/4 MNPT Inlet x 1/4 MNPT Outlet 1/4 Male Flare x 1/4 Male Flare
<b>Stainless Body Options</b>	1/4 MNPT Inlet x 1/4 MNPT Outlet
<b>Cracking Pressure</b>	302 Stainless Spring – 1 psi (Standard), 3.7, 5, 10, 14, 18 psi, No Spring
<b>Plating Options</b>	No Plating (Standard), Electroless Nickel

### Example of How To Order

Body Material	Inlet End	Outlet End	Spring	Plating
Brass	1/4 MNPT	1/4 FNPT	14 psi	None

**SMC Part Number: CHK BRS 460-4M4F,14#**

The flow arrow on the body will point from Inlet to Outlet. SMC Part Numbers are a description of the valve as read left to right, Inlet to Outlet.

Example: CHK BRS 460-4M4F,14# = 1/4 MNPT Inlet x 1/4 FNPT Outlet

**SMC will quote alternate materials or customize our standard products when quantities ensure competitive pricing.**