



Vertically Integrated, Made in the USA

THE SPECIALTY MFG. CO.

5858 Centerville Road • St. Paul, MN 55127-6804
 Tel: (651) 653-0599 • Fax: (651) 653-0989
 www.specialtymfg.com • e-mail: info@specialtymfg.com

410 SERIES CHECK VALVE

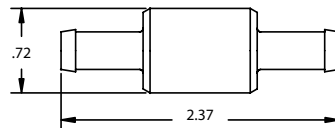
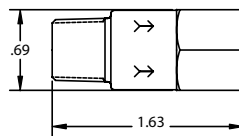
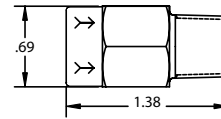
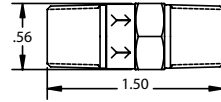

Design Considerations

The 410 Series Piston Check Valve incorporates a piston with an embedded o-ring that seals on the seat. Pressure in the flow direction moves the piston and seal off the seat and exposes the cross holes in the piston. The 410 Series Check Valve maximum operating pressure of 500 psi covers a wide range of air and fluid applications. The 410 Check is a compact design and has a positive seal at very low back pressure or slight vacuum. UL / UR configurations are available and rated to 500 psi.

Maximum Operating Pressure — 500 psi
 Maximum Operating Temperature — 180°F
 Seat Area Open Diameter — .203

Options

Material Options	Brass Body and Piston, Beryllium Copper Retainer 316 Stainless Body and Piston, 15-7 Stainless Retainer	
Seal Options	Buna-N, Ethylene Propylene, Fluoroelastomer (Viton®) Neoprene, AFLAS, Perfluoro Elastomer	
Brass End Options	1/4 MNPT Inlet x 1/4 MNPT Outlet 1/4 MNPT Inlet x 1/4 FNPT Outlet	1/4 FNPT Inlet x 1/4 MNPT Outlet 5/16 Hose Barb x 5/16 Hose Barb
Stainless End Options	1/4 MNPT Inlet x 1/4 MNPT Outlet 1/4 MNPT Inlet x 1/4 FNPT Outlet	1/4 FNPT Inlet x 1/4 MNPT Outlet
Cracking Pressure	302 Stainless Spring - 1 psi (Standard), 1/3, 3, 5, 10, 20, 25 psi, No Spring Hastelloy Spring - 1, 3, 5, 15, 25 psi	
Plating Options	No Plating (Standard), Electroless Nickel	

Body Material Stainless	Inlet End 1/4 FNPT	Outlet End 1/4 MNPT	Seal Viton®	Spring 3 psi, Hastelloy	Plating None
-----------------------------------	------------------------------	-------------------------------	-----------------------	-----------------------------------	------------------------

The flow arrow on the body will point from Inlet to Outlet. SMC Part Numbers are a description of the valve as read left to right, Inlet to Outlet.
 Example: CHK SST 410-4F4M-F,3#, HAST = 1/4 FNPT Inlet x 1/4 MNPT Outlet

SMC will quote alternate materials or customize our standard products when quantities ensure competitive pricing.