



Vertically Integrated, Made in the USA

THE SPECIALTY MFG. CO.

5858 Centerville Road • St. Paul, MN 55127-6804
Tel: (651) 653-0599 • Fax: (651) 653-0989
www.specialtymfg.com • e-mail: info@specialtymfg.com

212 SERIES CHECK VALVE

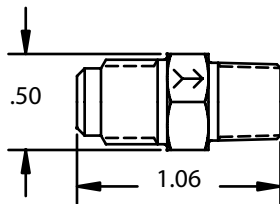
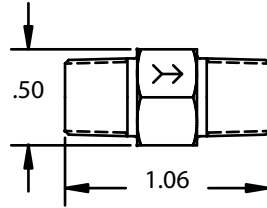

Design Considerations

The 212 Series Poppet Check Valve incorporates a poppet with an embedded o-ring that seals on a brass seat. The 212 Series Check Valve maximum operating pressure of 500 psi covers a wide range of air and fluid applications. The 212 Check is a compact design and has a positive seal at very low back pressure or slight vacuum. UL / UR configurations are available and rated to 500 psi.

- Maximum Operating Pressure — 500 psi
- Maximum Operating Temperature — 180°F
- Seat Area Open Diameter — .128

Material Options	Brass Body, Poppet and Retainer
Seal Options	Buna-N, Ethylene Propylene, Fluoroelastomer (Viton®), Neoprene
End Options	1/8 MNPT Inlet x 1/8 MNPT Outlet 1/4 Male Flare Inlet x 1/8 MNPT Outlet 1/8 MNPT Inlet x 1/4 Male Flare Outlet 1/4 Male Flare x 1/4 Male Flare
Cracking Pressure	302 Stainless Spring – 1/2 psi
Plating Options	No Plating (Standard), Electroless Nickel

Body Material	Inlet End	Outlet End	Seal	Spring	Plating
Brass	1/8 MNPT	1/8 MNPT	Viton®	1/2 psi	None

The flow arrow on the body will point from Inlet to Outlet. SMC Part Numbers are a description of the valve as read left to right, Inlet to Outlet.

Example: CHK BRS 212-2M2M-F,1/2# = 1/8 MNPT Inlet x 1/8 MNPT Outlet

SMC will quote alternate materials or customize our standard products when quantities ensure competitive pricing.