

## STAB APPLICATION, STAINLESS STEEL QUICK COUPLINGS

The SSR60 Series is a special purpose, 303 Stainless Steel "Stab Application" coupling, meaning the mating halves are mechanically retained in the application. This is a proprietary interchange. Special seals are used for both media compatibility and extreme external temperatures. This coupler is suitable for low pressure applications.

- SSR60 series comes standard with external O-ring boss threads. Consult factory for an optional face seal port.
- Minimum air inclusion during connection and minimum fluid spillage during disconnection.
- Standard seal suitable for use with Ethylene Glycol or Propylene Glycol solutions.
- All SSR60 series couplings are 100% leak tested before leaving factory.
- Thread protectors installed to protect threads and to retain O-rings on parts prior to installation.
- Alignment issues in stab applications minimized due to SafeWay's self-aligning feature.
- Method of obtaining and presenting performance data conforms to ANSI (NFPA) T3.20.2.R2, *Hydraulic fluid power - Quick action couplings - Test methods*.



SSR601-2-6E

SSR605-2-6E

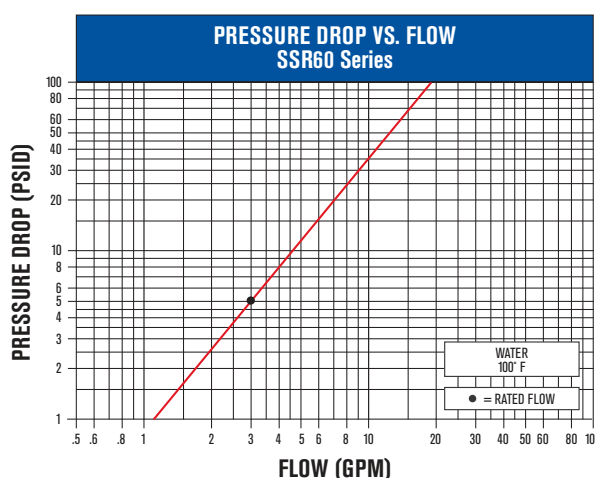

## PERFORMANCE DATA

PART NUMBERS			DESCRIPTION		OPERATING PRESSURE		NFPA RATED FLOW	
Complete Coupler	Female Body Half	Male Tip Half	Body Size	Thread Size and Description	Maximum			
					PSI	(BAR)	GPM	(LPM)
SSR60-2-6E	SSR605-2-6	SSR601-2-6E	1/4"	9/16"-18 Male	100	(7)	3	(12)

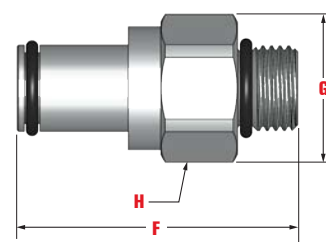
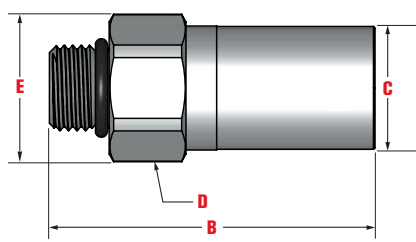
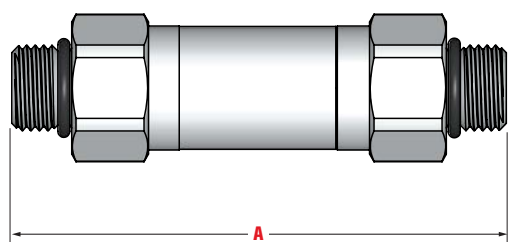

## DIMENSIONAL DATA

Overall Length	Body Length	Diameter	Hex	Diameter	Tip Length	Diameter	Hex
A	B	C	D	E	F	G	H
3.22	2.12	.80	.88	.96	1.82	.96	.88

# LARGE QUICK CONNECTOR (LQC)



PART NUMBERS	
Socket - No Color Indicator	SW101705
Socket - Red Indicator	SW101705-R
Socket - Blue Indicator	SW101705-B
Plug - No Color Indicator	SW101701
Plug - Red Indicator	SW101701-R
Plug - Blue Indicator	SW101701-B

## Thread-to-Connect, High Flow

- Connect/disconnect while pressurized up to 35 psi
- Dry break and heavy-duty
- Ergonomically designed to connect by hand, 3ft. lbs torque to mate
- Optimized for minimal flow restriction
- Colored O-rings to indicate direction
- Valve type: O-ring poppet
- All wetted components stainless or EPDM
- Dimensional and performance requirements conform to OCP Large Quick Connector (LQC) Specification

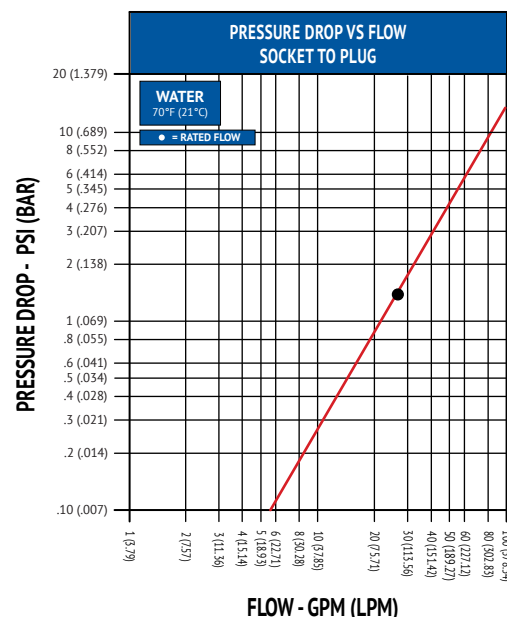

## PERFORMANCE & PHYSICAL ATTRIBUTES

Body Size	Body Material	Thread Size	Thread Description	Max. Operating Pressure	Rated Flow		Max. Spillage Per Disconnect	Weight
1" (25.4 mm)	Stainless Steel	1" (25.4 mm)	BSPP	175 PSI (12 Bar)	26 GPM	100 LPM	<0.15 mL @14.5 PSI	3.04 LBS (1.38 KG)

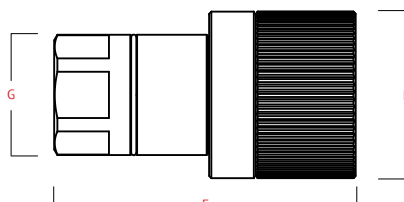

PLUG (SW101701)

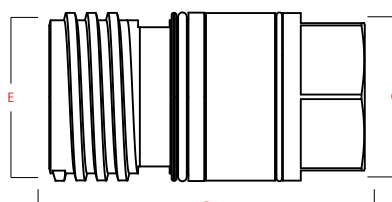

SOCKET (SW101705)

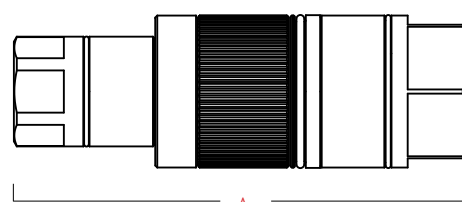

FULLY MATED

## DIMENSIONAL DATA

A	B	C	D	E	F	G	H	I
6.13" (155.7 mm)	3.75" (95.3 mm)	1.99" (50.5 mm)	1.75" (44.5 mm)	1.99" (50.5 mm)	4.07" (103.4 mm)	1.63" (41.4 mm)	1.50" (38.1 mm)	2.25" (57.2 mm)

Temperature Range: Standard seals EPDM max operating temperature 140°F (60°C). Vacuum Data: 27.4 inches Hg. both connected and disconnected pressure rating (Max. Operating Pressure) is based on non-pulsating, low cycle applications with essentially steady pressure during the operating cycle. Please consult factory regarding other applications.

View additional product information online



# BLIND MATE QUICK CONNECTOR (BMQC)



PART NUMBERS	
Plug (male half)	SW101511
Socket (female half)	SW101505

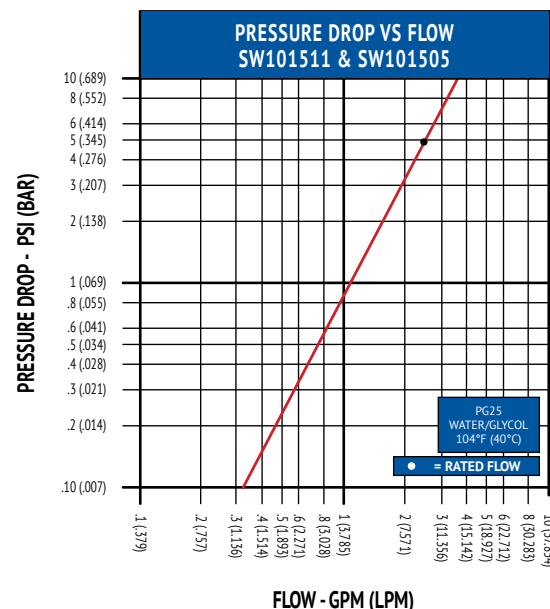

## Self-Aligning & Rack Integratable

- Blind mate quick connector designed for rack integrated liquid cooling solutions
- Supports up to 5mm of radial misalignment and up to 2.74° of angular misalignment
- Meets or exceeds dimensional and performance requirements for OCP ORv3 BMQC specification
- Lower restriction than other brands while maintaining conformance to specification
- Lower average mate force than other brands
- Wetted Components: Stainless Steel and EPDM
- Connection Style: Blind Mate, dry break
- Valve Type: Poppet/O-ring Seal

## PERFORMANCE & PHYSICAL ATTRIBUTES

Body Size	Body Material	Socket Thread Size	Plug Barb Size	Max. Operating Pressure	Rated Flow		Max. Spillage Per Disconnect	Complete Weight
0.2" (5 mm)	Stainless Steel	3/4-16" UNF (SAE)	3/8" barb (10 mm)	50 PSI (3.5 Bar) <small>*Based on hose capability</small>	2.4 GPM	9 LPM	.05 mL @ 50 PSI .025 mL @ 0 PSI	0.74 LB (.34 KG)

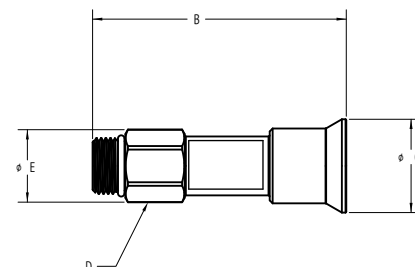
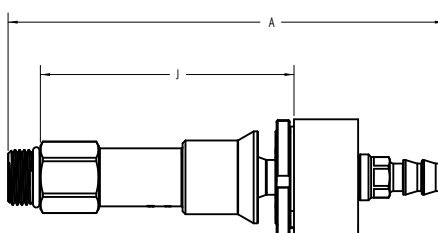
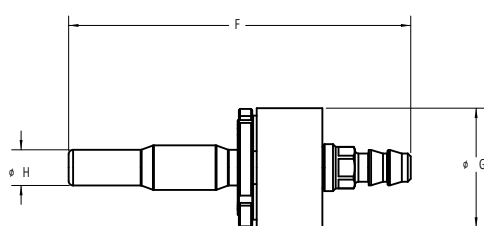

## DIMENSIONAL DATA

A	B	C	D	E	F	G	H	J
5.93" (150.6 mm)	3.39" (86.1 mm)	1.25" (31.7 mm)	.866" (22 mm)	.97" (24.6 mm)	4.54" (115.3 mm)	1.58" (40.1 mm)	.47" (11.9 mm)	3.44" (87.4 mm)

Temperature Range: Standard seals EPDM max operating temperature 140°F (60°C). Vacuum Data: 27.4 inches Hg. both connected and disconnected pressure rating (Max. Operating Pressure) is based on non-pulsating, low cycle applications with essentially steady pressure during the operating cycle. Please consult factory regarding other applications.

View additional product information online



# UNIVERSAL QUICK DISCONNECT (UQD)



PART NUMBERS	
Socket	SW102025-R SW102025-B
Plug	SW102021-R SW102021-B

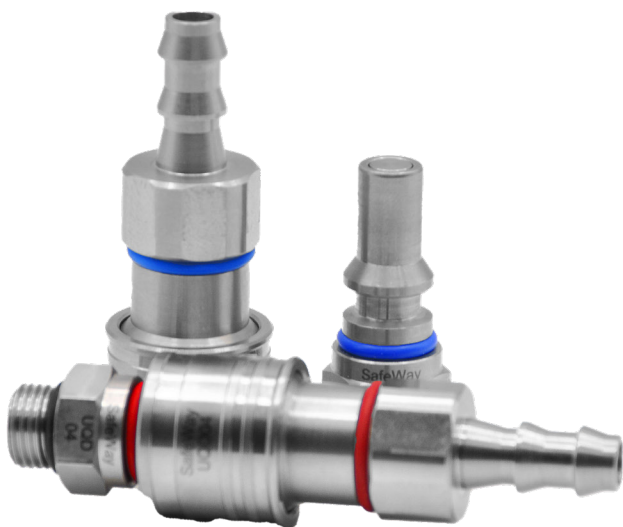

## UQD04

- Designed for rack integrated liquid cooling solutions
- Dimensional and performance requirements conform to OCP Universal Quick Disconnect (UQD) Specification rev 1.0
- Stainless steel and EPDM wetted components
- Colored O-Ring for identification

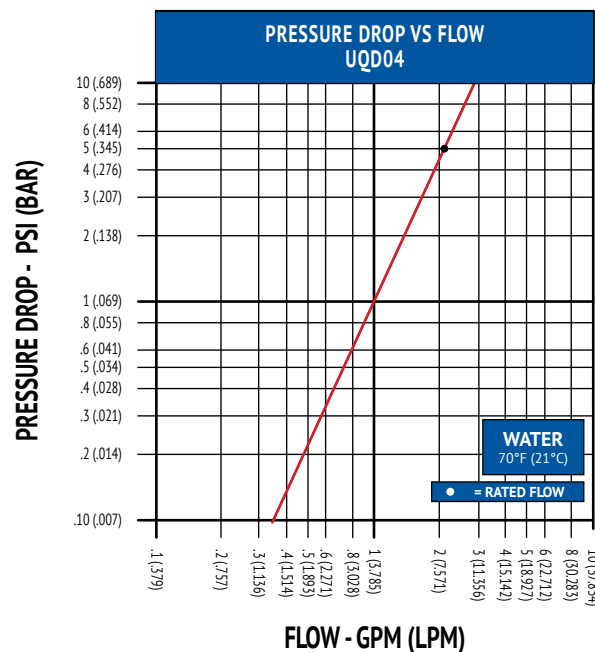

PERFORMANCE & PHYSICAL ATTRIBUTES								
Body Size	Body Material	Plug Thread Size	Socket Barb Size	Max. Operating Pressure	Rated Flow		Max. Spillage Per Disconnect	Complete Weight
1/4" (6.4 mm)	Stainless Steel	9/16-18" UNF (SAE)	3/8" (10 mm)	100 PSI (7 Bar) <small>*Based on hose capability</small>	2.2 GPM	8.2 LPM	.012 mL @0 PSI	.39 LB (.18 KG)

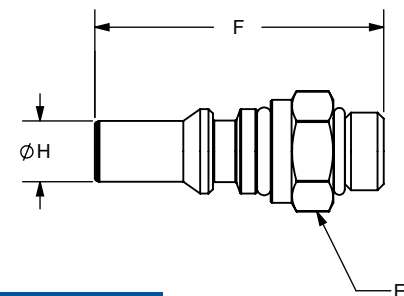
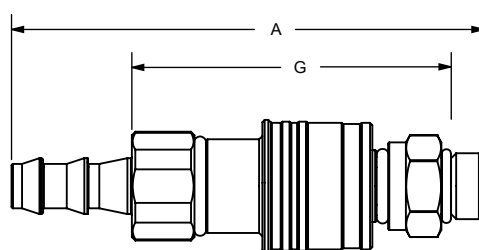
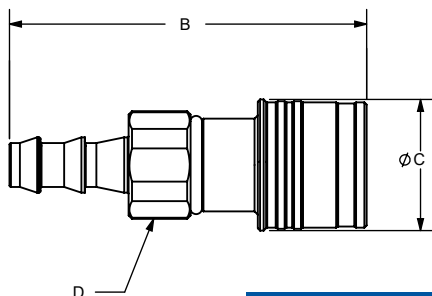

DIMENSIONAL DATA							
A	B	C	D	E	F	G	H
3.99" (101.3 mm)	3.05" (77.5 mm)	1.12" (28.4 mm)	0.875" (22.2 mm)	0.75" (19 mm)	2.07" (52.6 mm)	2.61" (66.3 mm)	.44" (11.2 mm)

Temperature Range: Standard seals EPDM max operating temperature 150°F (65°C). Vacuum Data: 27.4 inches Hg, both connected and disconnected pressure rating (Max. Operating Pressure) is based on non-pulsating, low cycle applications with essentially steady pressure during the operating cycle. Please consult factory regarding other applications.

View additional product information online

