



Vertically Integrated, Made in the USA

THE SPECIALTY MFG. CO.

5858 Centerville Road • St. Paul, MN 55127-6804

Tel: (651) 653-0599 • Fax: (651) 653-0989

www.specialtymfg.com • e-mail: info@specialtymfg.com

052 SERIES BALL VALVE

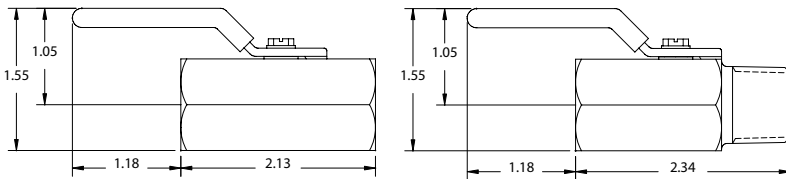

Design Considerations

The 052 Series Two-Way Ball Valve compact design has a one piece body construction to cover 1/2" NPT end configuration applications. The 052 Ball Valve Series is rated to 500 psi and will support flow and pressure in either direction. The Steel Lever Handle is standard and can be ordered Reversed - to lie over the outlet when the valve is in the open position. UL configurations are available and rated to 250 psi. UR configurations are available and rated to 500 psi.

- Maximum Operating Pressure — 500 psi
- Maximum Operating Temperature — 180°F
- Ball Through Hole Diameter — .375

Options

Material Options	Brass Body, Nickel Plated Brass Ball, Teflon® Seats, Stainless Handle Screw
Seal Options	Buna-N, Ethylene Propylene, Fluoroelastomer (Viton®), Neoprene
Body Options	1/2 Female x 1/2 Female NPT 1/2 Female x 1/2 Male NPT
Handle Options	Steel Lever with Red Vinyl Sleeve (Standard)
Plating Options	No Plating (Standard), Electroless Nickel

Example of How To Order

Inlet End 1/2 FNPT	Outlet End 1/2 MNPT	Seal Buna-N	Handle Reversed	Plating ENP
------------------------------	-------------------------------	-----------------------	---------------------------	-----------------------

SMC Part Number: 052-8F8M-B,RH,ENP

The handle will lie over the Inlet port when the valve is in the open position. SMC Part Numbers are a description of the valve as read left to right, Inlet to Outlet.

Example: 052-8F8M-B,RH,ENP = 1/2 FNPT Inlet x 1/2 MNPT Outlet

SMC will quote alternate materials or customize our standard products when quantities ensure competitive pricing.